

# CONVULSING ZOMBIE

## INSTALLATION AND OPERATING INSTRUCTIONS

KEEP ALL PLASTIC AND WIRE PARTS AWAY FROM CHILDREN

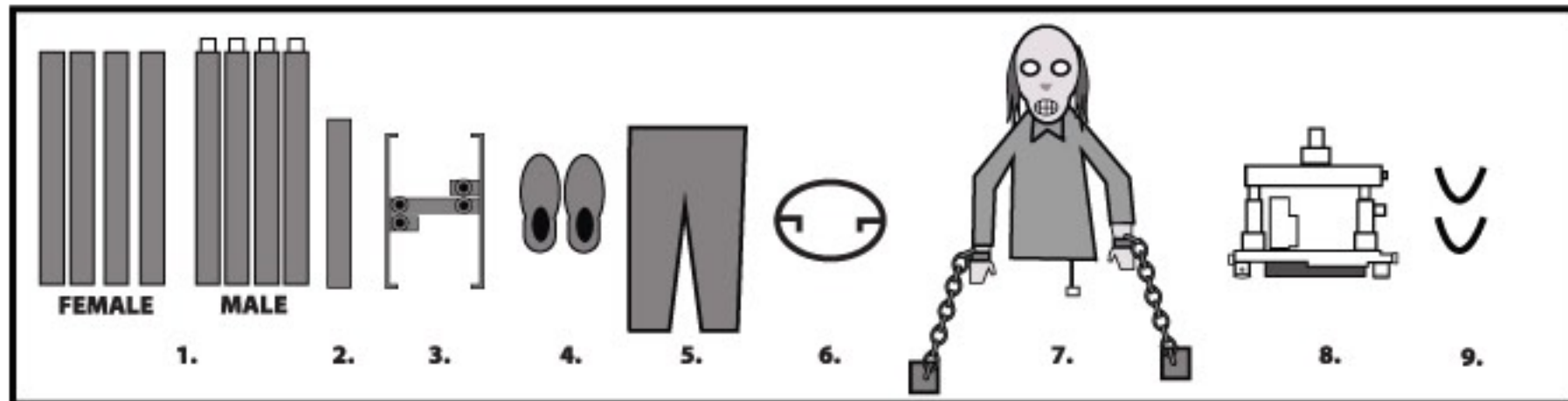

### PARTS

1. LONG POLES (4 FEMALE & 4 MALE)
2. SHORT POLE (FEMALE / FEMALE)
3. METAL STAND
4. SHOES (2)
5. PANTS
6. PANTS BRACKET
7. HEAD WITH ARMS AND CHAINS
8. MODULE
9. LOCKING PINS

1. Assemble **LONG POLES**, 4 MALE TO 4 FEMALE (Match **A** to **A**). Twist to lock.

2. Attach **LONG POLES** to **METAL STAND**.

3. Slide **SHOES** over assembled **LONG POLES** connected to **METAL STAND**.

4. Slide **PANTS** over assembled **LONG POLES** connected to **METAL STAND**.

5. Attach **MODULE** to assembled **LONG POLES**.

**Note:** **MODULE** labeled **FRONT** should be pointing same way as the front of shoes.

6. Locate holes in the top of the **LONG POLE**. Turn the pole and line up hole in top of the **LONG POLE** with the hole on **MODULE**. (Holes are located on **MODULE front left** and **MODULE back left**.) Insert **LOCKING PIN** as illustrated. (See illustration 6 and 6a)

7. Attach **PANTS BRACKET** to **MODULE** inserting metal prongs facing down. (See illustration 7)

8. Attach **SHORT POLE** to **HEAD WITH ARMS AND CHAINS**. (Match **B** to **B**) Twist to lock.

9. Attach opposite end of **SHORT POLE** to **MODULE**. (Match **B** to **B**) Twist to lock.

10. Connect cable located under clothes to cable coming from **MODULE**. (Match **C** to **C**)

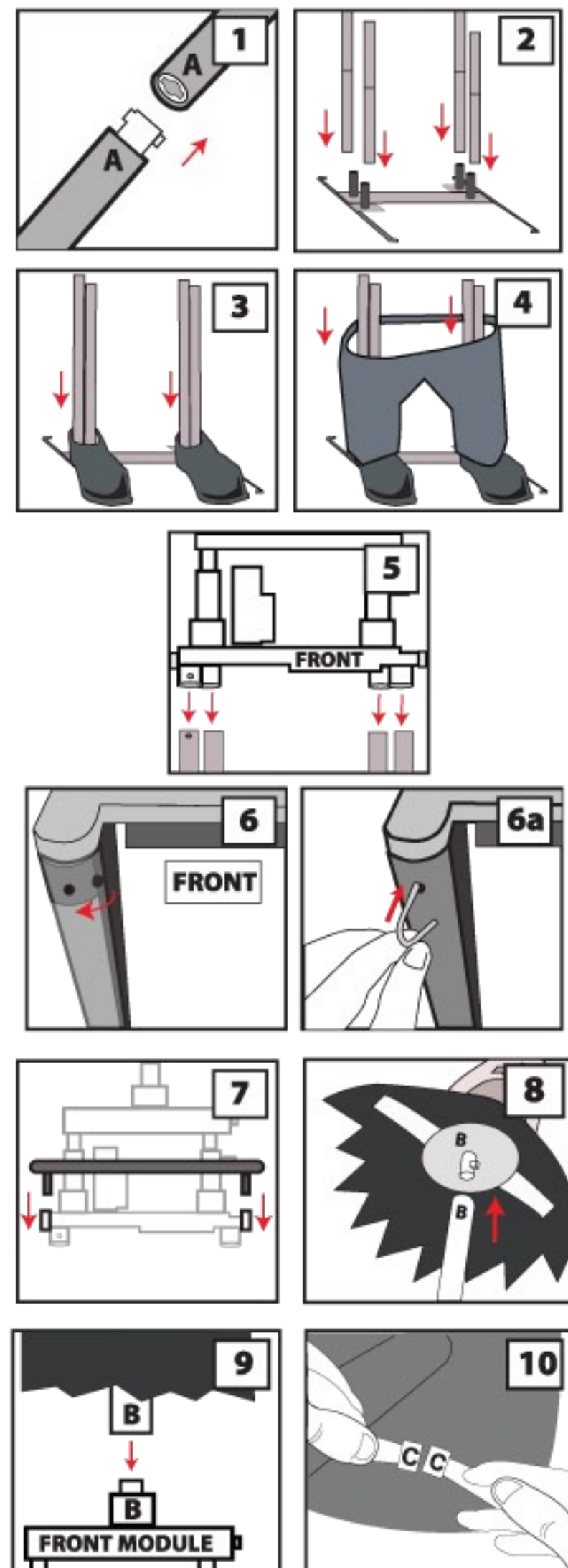

11. Pull **PANTS** up to **PANTS BRACKET** and secure four hook and loop fasteners around the **PANTS BRACKET**.

12. Use 3M adhesive located on the back of the chain brackets to secure brackets to the desired surface.

**Note:** Use caution when selecting surface to attach chains. Adhesive may cause damage to some surfaces.

13. Insert 4 AA batteries (not included) into the battery compartment located on the **MODULE** or connect 6V 2A adapter. (sold separately)

**Note:** Turn switch on top of **MODULE** to ON to operate in sound & motion activation mode. Leave switch in OFF position when not in use.

14. Pull Convulsing Zombie's shirt down and adjust for "un"life-like appearance!

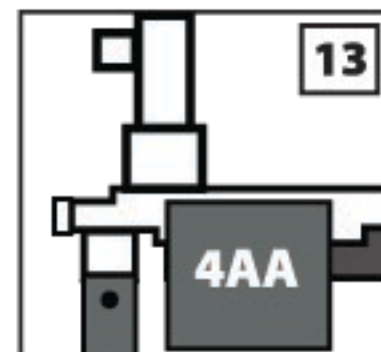
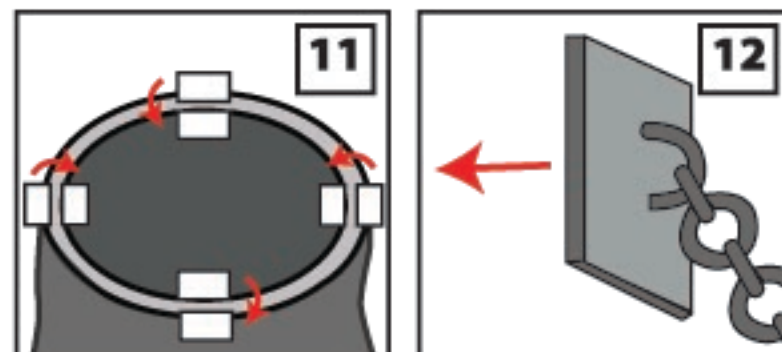

## Optional Footpad Setup

Follow Steps 1 through 13 on initial installation first.

1. Connect wire from the optional footpad to the jack labeled FOOTPAD located on the base.
2. Place the switch on the base into the 'FOOTPAD' position to enable FOOTPAD activation.
3. Step on FOOTPAD to activate the scary sequence.

### NOTE:

When plugging in, make sure pins line up properly with holes on plug. Align plug, groove side down, with the notch.

### CAUTION!

Not aligning the plug to jack properly may cause permanent damage to footpad jack of your item. **DO NOT** use excessive force when inserting plug.

\*Footpads are sold separately and can be purchased online at: [www.tekkytoys.com](http://www.tekkytoys.com)

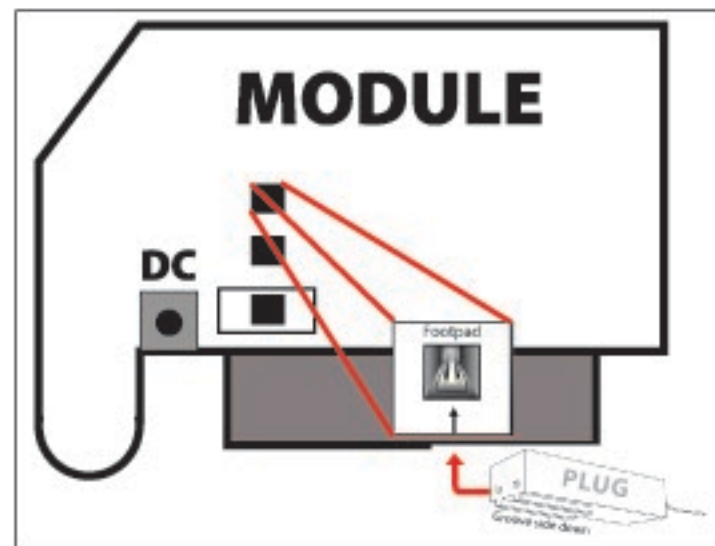

**\*\*No weight should be placed onto item\*\***

**Warning! This item is not a toy. For decoration only. Small parts, choking hazard.**  
This product is intended for use by persons 15 years of age and older.  
Not intended for use by children ages 14 years and younger.

### WARNING

**DO NOT TURN THIS ITEM ON UNTIL YOU HAVE COMPLETELY FINISHED ASSEMBLY.**

**Stay clear of item while operating.**

**SMART PHONE SCAN**  
SETUP VIDEO



VISIT US: [WWW.TEKKYTOYS.COM](http://WWW.TEKKYTOYS.COM)

Surface Washable Only.  
ALL NEW MATERIALS : PLASTIC,  
POLYESTER, POLYESTER FIBER

Battery Powered:  
Requires 4 AA Batteries (not included)  
Optional DC Adapter Ready (6V 2A)  
\*\*DC Adapter and footpad sold  
separately and can be purchased  
at: [www.tekkytoys.com](http://www.tekkytoys.com)  
Convulsing Zombie is a trademark  
of Tekky Toys.  
Copyright © 2012 Tekky Toys.  
All Rights Reserved.  
MADE IN CHINA



**DO NOT RETURN THIS ITEM TO THE STORE!**  
If experiencing technical difficulties, please go to  
[www.tekkytoys.com](http://www.tekkytoys.com) for assistance.

